

THULE
SWEDEN

- | | |
|---------------------------------------|-------------------------------------|
| GB Fitting instructions | SK Návod na montáž |
| D Montageanleitung | SLO Navodila za pritrjevanje |
| F Instructions de montage | HR Uputa za sastavljanje |
| NL Montage-instructies | HU A felszerelés módja |
| I Istruzioni per il montaggio | GR Οδηγίες συναρμολόγησης |
| E Instrucciones de montaje | TR Montaj talimatları |
| PT Instruções de Montagem | 中文 安装说明 |
| S Monteringsanvisning | 日本語 取扱(取付)説明書 |
| FIN Asennusohje | 한국어 장착 지침 |
| EST Paigaldusjuhend | ไทย คำแนะนำการติดตั้ง |
| LAT Stiprināšanas instrukcija | |
| LIT Pritvirtinimo instrukcijos | |
| PL Instrukcja montażu | |
| RU Инструкции по установке | |
| CZ Návod na montáž | |

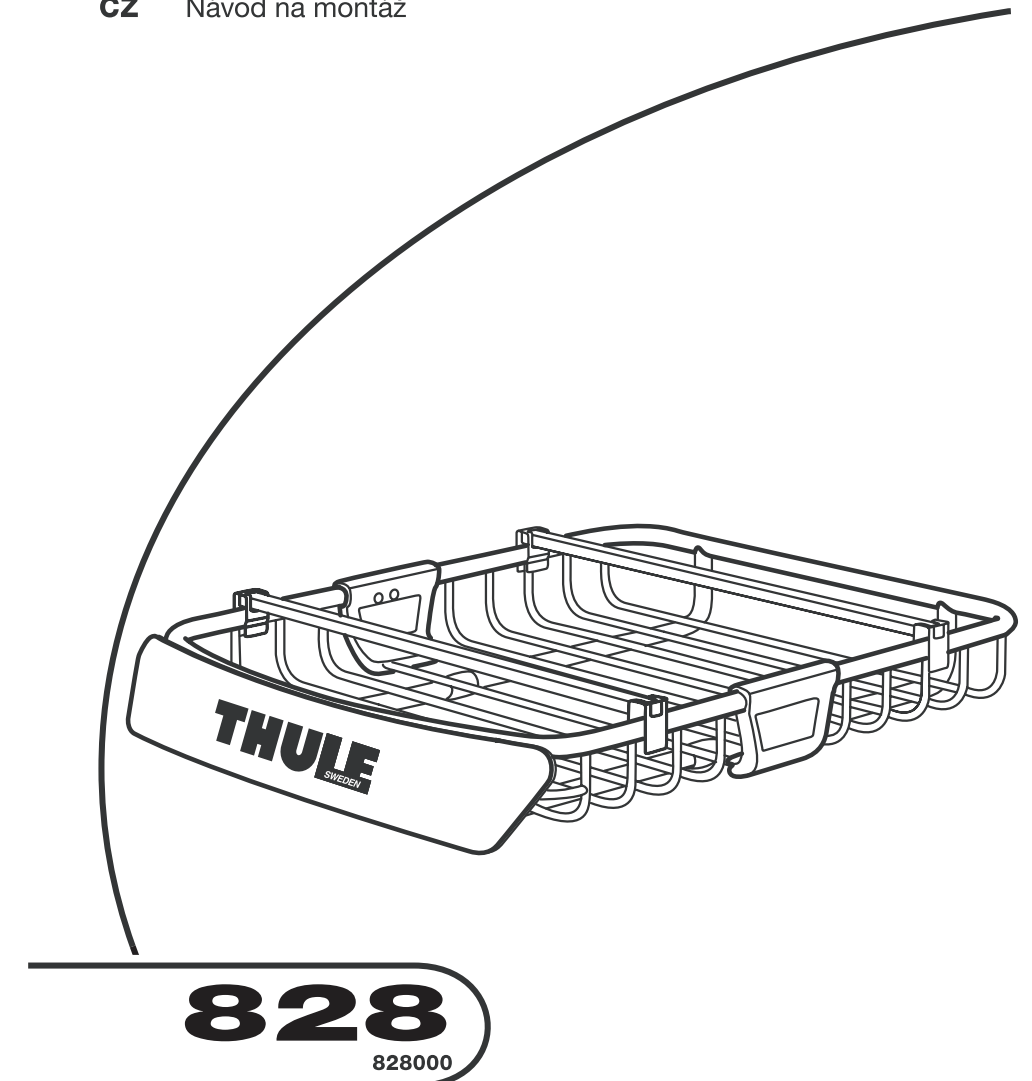

Follow me...

THULE
SWEDEN
Box 69, 330 33 Hillerstorp, SWEDEN
www.thule.com

731•3DF2/501-7242



THULE

- GB Security regulations
- D Sicherheits-Vorschriften
- F Instructions importantes
- NL Veiligheidsvoorschriften
- I Norme di sicurezza
- E Regles de sécurité
- PT Normas de segurança
- S Sikkerhedsforskrifter
- FIN Turvallisuusohjeet
- EST Ohutusjuhised
- LAT Drošības noteikumi
- LIT Saugumo taisyklės
- PL Wskazówki bezpieczeństwa
- RU Инструкция по безопасности
- CZ Nikdy na montáž
- SK Bezpečnostné predpisy
- SLG Varnostni predpisi
- HU Biztonsági előírások
- GR Κοινωνικοί Ασφαλιστές
- TR Güvenlik kuralları
- 中文 安全提示
- 한국어 안전지침
- ไทย มาตรการความปลอดภัย

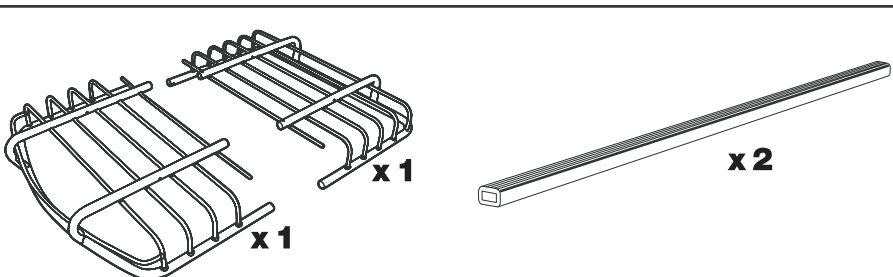
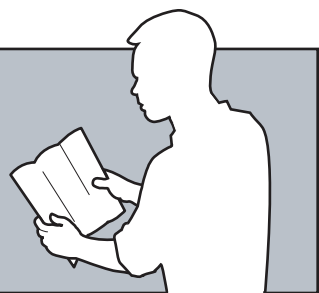
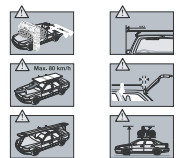

1500050930

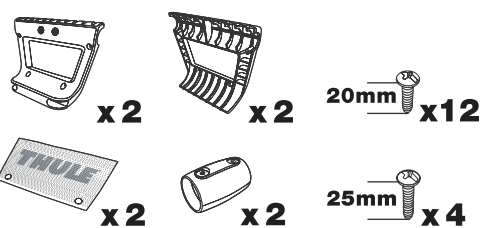

1500050931

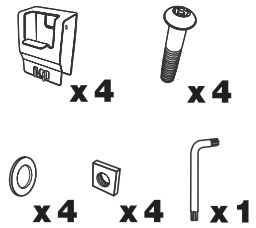

1500050932

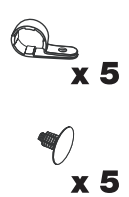

1500050933



1500050934

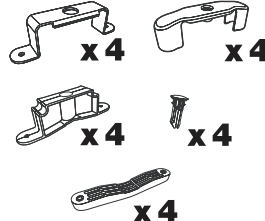

1500050935

